

## Safety withdrawal valve AG101

### APPLICATION

Safety withdrawal valves are designed to allow easy and quick evacuation of product stored in a tank.

Safety withdrawal valves incorporate excess flow valve, which limits or closes the flow completely if the rate of flow exceeds maximum design flow.

Safety withdrawal valves can also be used as separation valves mounted in a tank, before shut off valve. Safety withdrawal valve used for this purpose allows for replacement of shut off valve without the need of evacuating the tank.



### MATERIAL SPECIFICATION

Body: brass

Valve disc: brass

Spring: stainless steel

Stem: brass

Seals: synthetic rubber (NBR)

Gasket: Nylon

### TECHNICAL PARAMETERS

Tank connection: 1 1/4" M.NPT

Hose or pipeline connection: 3/4" F.NPT

Approximate closing flow: 133 l/min

Max pressure: 27,5 bar

### DIMENSIONS

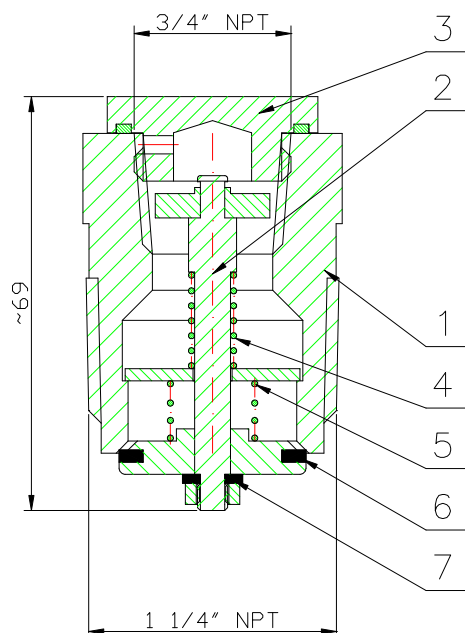

1. Body
2. Stem
3. Cap
4. Spring
5. Excess flow valve spring
6. Valve poppet
7. Gasket