

## LPG hose reel type ZO

### Application

Hose reels type ZO are manufactured in explosion proof technology. It can be used with three types of drives: hydraulic, pneumatic and manually operated. It can be used as single or double reel system with liquid and vapor return lines. Constructed of aluminum with the exception of main piping to ensure low weight and perfect resistance to environment conditions.

**Connections:** Inlet flange DN40, outlet 1 1/2" FNPT.

**Working pressure:** 24 bar.

**Working temperature:** -40 °C to 60 °C



### Dimensions:

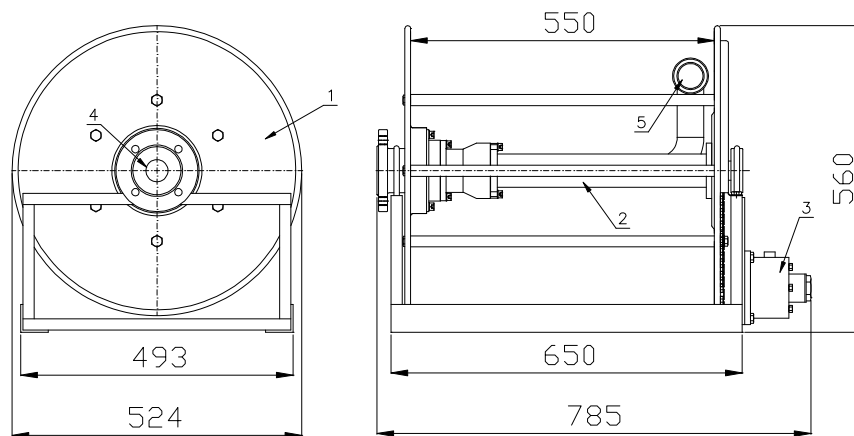

### Technical parameters

Working pressure:	25 bar
Nominal diameter:	DN40
Hose length:	for DN40 - approx. 40m for DN32 - approx. 45m

- drive: pneumatic  
(option: hydraulic, electric or manual)
- Excess flow valve
- Swivel joint
- Bearing
- Minimal flow resistance

*Notice:* Parameters could be changed as a result of construction changes.

### Reels types:

**Type ZO-01** – without excess flow valve

**Type ZO-02** – with excess flow valve

**Notice: Both reels are the same dimensions!**